



Haverhill Area Working Party 23 July 2009

Addition to Haverhill Range of Bespoke Street Furniture: Raised Planter for Trees and Shrubs

1. Purpose of the Report

- 1.1 The purpose of the report is to propose an addition to the approved range of bespoke street furniture for Haverhill.**

2. Need for Addition to Range

- 2.1 Public consultation on improvement works to Queen Street, Haverhill indicated support for the inclusion of planting in the public realm. Opportunities for such planting can be limited but raised planters can extend the opportunities by avoiding conflicts with underground utilities and providing protection for small areas of planting.
- 2.2 Works to The Pightle as part of the Tesco development was to include tree planting alongside Stour Brook. As works have proceeded it has become apparent that the presence of unmarked underground services will likely preclude the excavation of tree pits in most situations and the option of using raised planters is probably going to be required. The submitted planter design was prepared for just this situation.

3. Co-ordinated Design

- 3.1 A planter design has been prepared in a style that would associate naturally with the 'Haverhill Range'. Key features include:-
- (a) simple plan profile: the shape is clearly identifiable as part of the range;
 - (b) durable: the primary material for fabrication would be mild steel which is highly durable;
 - (c) cost effective: the simple design and material specification would keep fabrication costs down;
 - (d) scalable: the design is scalable, planters could be made larger or smaller than the illustrated example without loss of identity; and
 - (e) optional 'perch' seat: a small seating element can be an optional extra on larger planters to add visual interest and functionality.

3.2

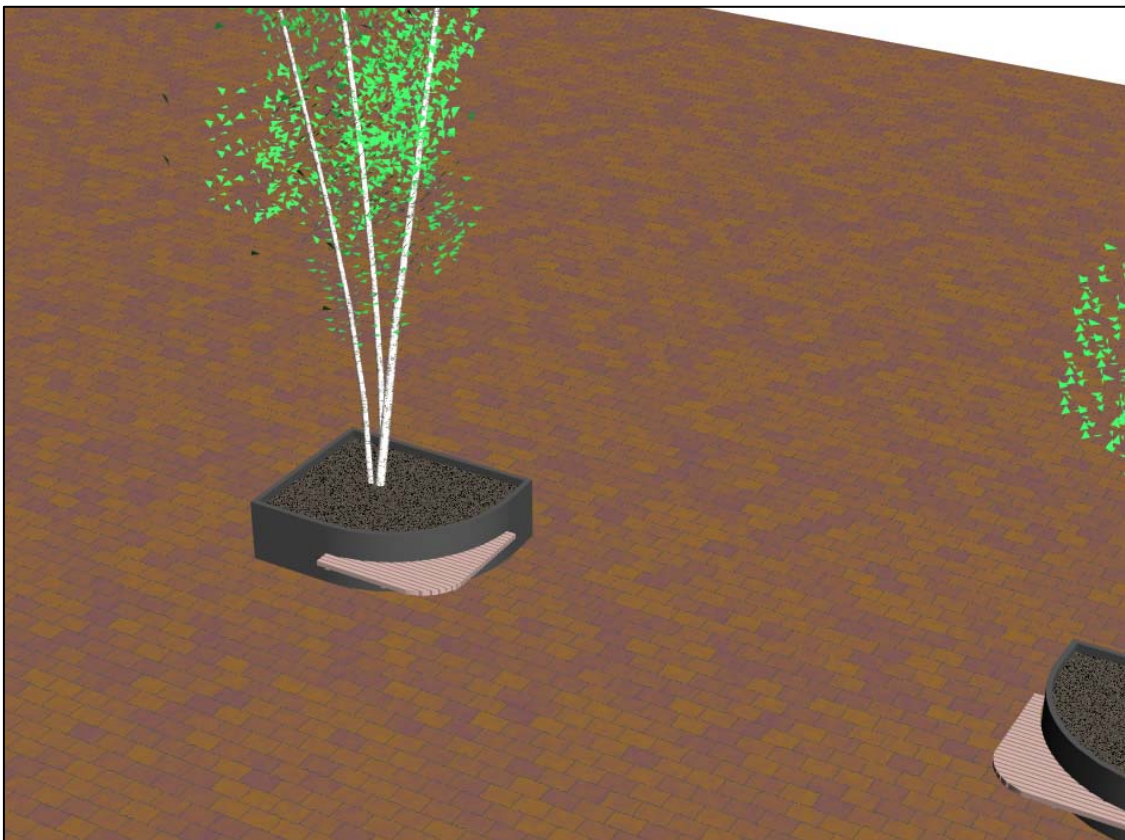
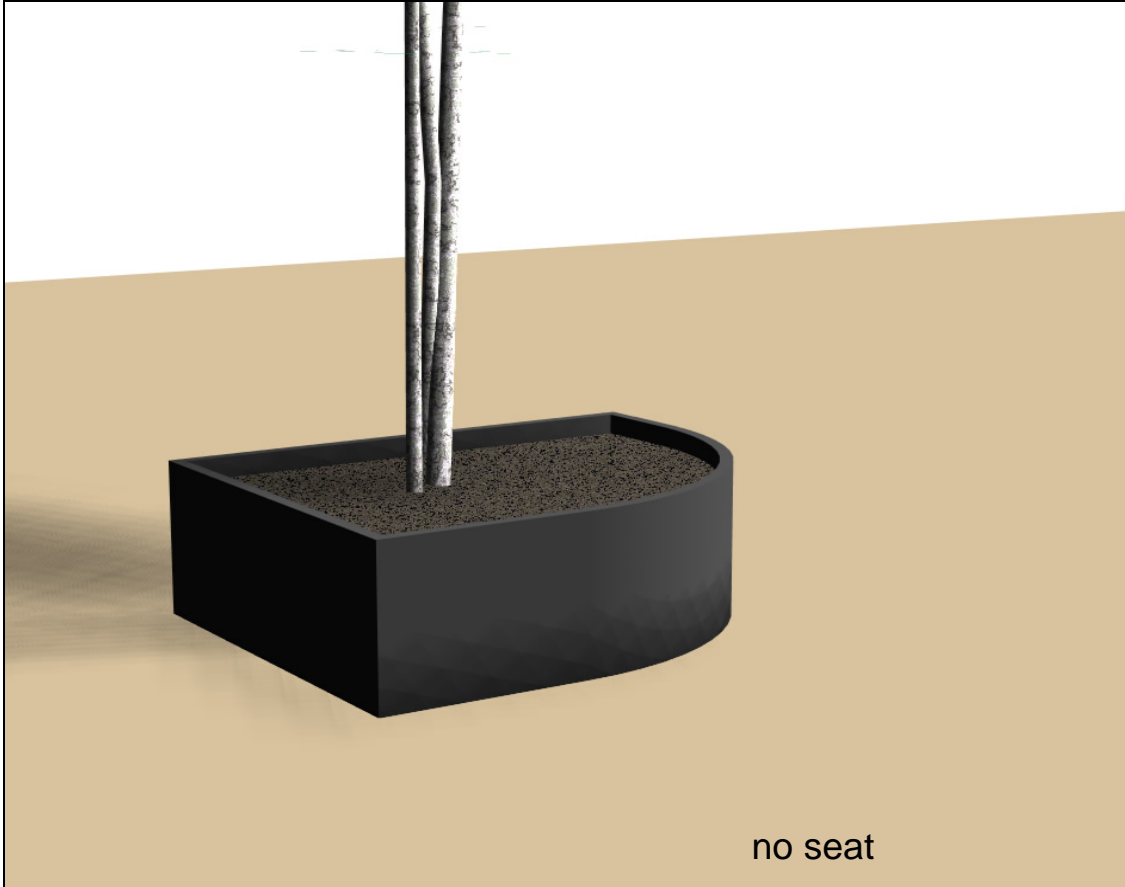

With optional seating element.

4. Recommendation

- 4.1 It is **RECOMMENDED** that the design for a raised planter for trees and shrubs, with the option to incorporate a 'perch' seating element, where appropriate, as detailed in Section 3.2 of Report A134 be approved as an addition to the 'Haverhill Range' of bespoke street furniture.

For further information, please contact:-

Ray Keeley, Principal Urban Design Officer

Telephone: (01284) 757615, or email: ramon.keeley@stedsbc.gov.uk

W:\Democratic WP Services\Committee\Reports\Haverhill Area Working Party\2009\09.07.23\Addition to Haverhill Range of Bespoke Street Furniture Raised Planter for Trees & Shrubs.doc